

Congratulations on the purchase of your Australian made Commercial-Max Roof Rack product.

Please read and follow the instructions carefully to ensure correct fitment.

Contact us if any parts appear missing, incorrect, or damaged.

Clean the roof prior to fitting the roof racks.

Tools Required:

- Spanner (13 & 17 mm)
- Silicone/urethane sealer

Kit Content

1 Commercial-Max Ford Transit LWB AV Front Left & Right Rails

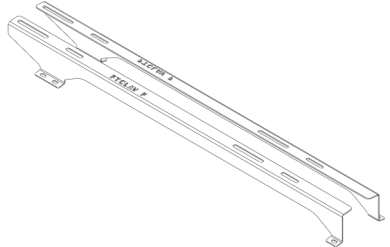

← x1

2 Commercial-Max Ford Transit LWB AV Rear Left & Right Rails

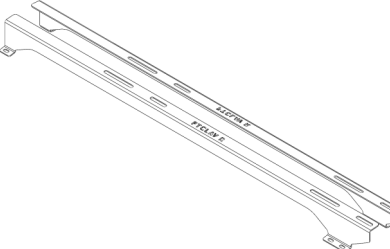

← x1

3 Commercial-Max Platform

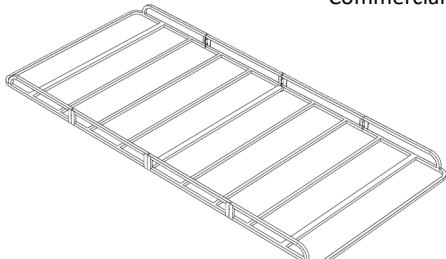

← x1

4

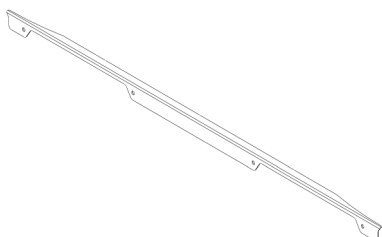

Wind Deflector Kit	
Item	Qty
Wind Deflector	1
M8 x 25 Sems Hex Bolt	4
8mm Nyloc Nut	4
M8 Flat Washer	4

← x1

5 M8 X 25 Sems Bolt Hex

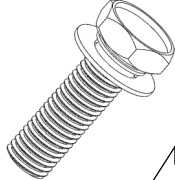

← x12

6 M10 X 25 Stainless Hex Bolt

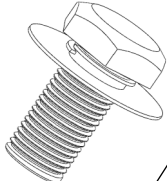

← x8

7 M10 Unistrut

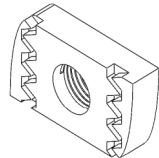

← x8

Assemble lugs to roof

1

- Remove 6 OEM plastic caps per sides in the roof channel to expose the factory mounting points.

2

- Apply silicone on all the roof channel mounting holes to prevent any water ingress.

3

- Place the supplied rails to the roof.
- Mount each rails on the roof using 8mm Bolts and washers

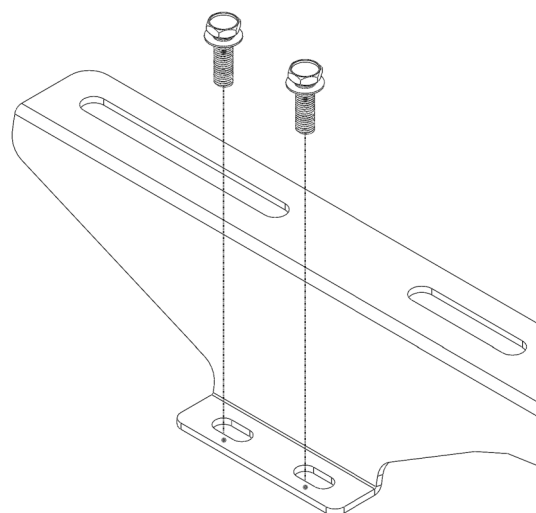

4

- Attach the channel nuts to the top of rail.
- Fit 10mm Bolt / Split washer / Flat washer / Channel Nuts to the top of rail.

* Channel nuts to the top as shown in the following diagram

NOTE-Ensure attach the channel nuts and bolt to correct mounting slot.



- Front Slot—lift up tailgate
- Rear Slot—Barn Door Version

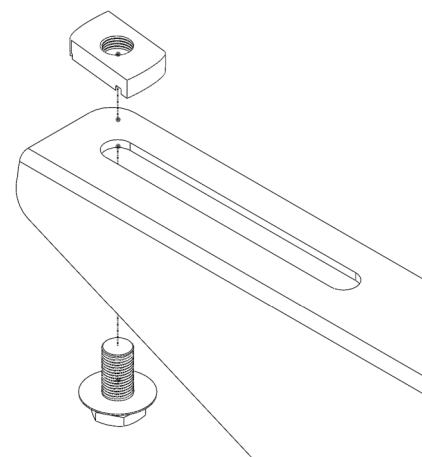

Assemble the Commercial-Max Platform to the rails

5

- Place the Commercial-Max Platform on the rails (Wind deflector mounting towards the front of vehicle), then spin the channel nuts 90 degree in the channel on the underside of the rack till they lock into the channels. Do not tighten fully.

NOTE— Align the rack to the suitable position and clearance for roller if fitted



Around 20-30mm from the tailgate to the back of the rack or roller is sufficient

6

- Centralize the rack side to side (using a tape measure) on the Commercial-Max rails.

7

- Fully tighten remaining bolts in the following order:
 1. Rails to the lugs
 2. Rails to platform
 3. Attach wind Deflector.

NOTE-Ensure the channel nuts are 90 degrees to the channels.



Check fastenings are firmly tensioned at regular intervals.

Do not overtighten, this will preserve the spring washers.



Fitting Note:

Where a wind deflector is used, we recommend a minimum of 15mm clearance from the vehicle roof.

Where necessary manually adjust the wind deflector or wind deflector mountings as required.

Thank you for your purchase.

Please complete your warranty application following correct installation.

TradeMax by Tradesman Roof Racks

Innovation through Inspiration