

# Wedgetail Trade Rails and Platform Fitting Instruction

To suit—Hyundai iLoad Van 2008—On  
RW-HIL-2514



**Congratulations on the purchase of your Australian made Wedgetail Trade Roof Rack product.**

Please read and follow the instructions carefully to ensure correct fitment.  
Contact us if any parts appear missing, incorrect, or damaged.  
Clean the roof prior to fitting the roof racks.

### Tools Required:

- Spanner (13mm,17 mm) • Drill & Drill Bit(5mm) • Silicone/urethane • Rivet Gun

### Kit Content

1

Wedgetail Trade Hyundai iLoad Front Left & Right Rails

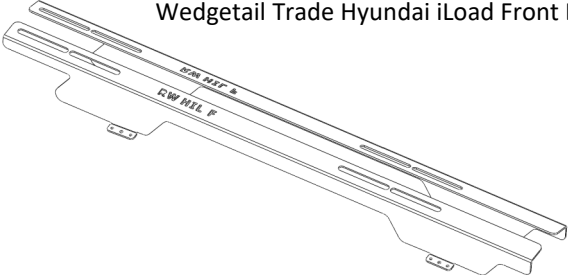

x1

2

Wedgetail Trade Hyundai iLoad Rear Left & Right Rails

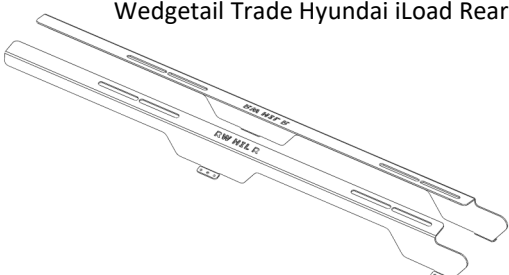

x1

3

Wedgetail Trade Platform Kit

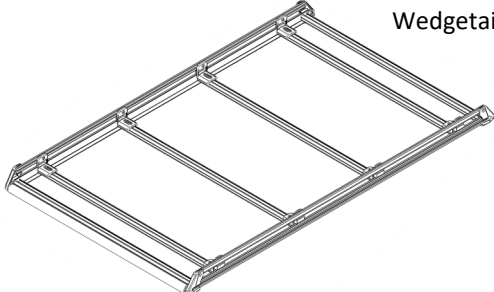

x1

4

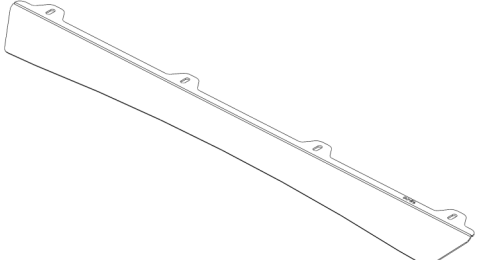

Wind Deflector Kit	
Item	Qty
Wind Deflector	1
M8 x 20 Hex Bolt	4
8mm Channel Nut	4
M8 Flat Washer	4
M8 Zinc Split Washer	4
M8 X 40 Flat Washer	4

5

16mm Rivet



x24

8

M10 X 20 Stainless Hex Bolt

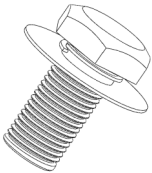

x8

7

M10 Unistrut

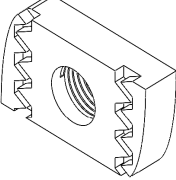

x8

# Wedgetail Trade Rails and Platform Fitting Instruction

To suit—Hyundai iLoad Van 2008—On

RW-HIL-2514



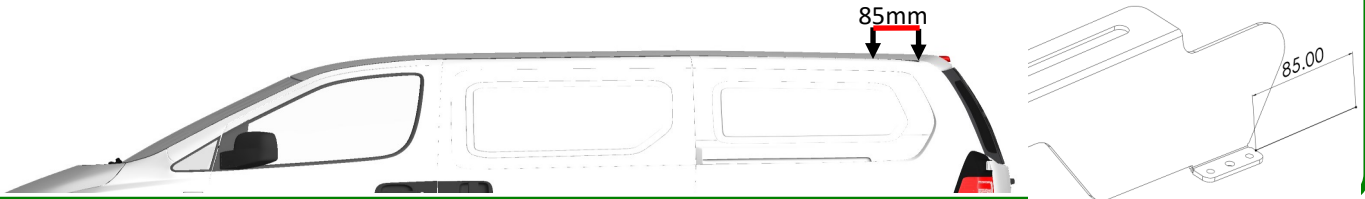

1

- Remove black strip from roof valley on both sides of the vehicle. Ensure valley/ recess is clear from dirt and debris
- Place the rear rails( Engraved HIL R) in the rear position as shown below. The rear mounting plate of the rails must be placed 85mm from the rear door line.



2

- Using the holes in the rail as a guide, begin drilling with a 20mm drill stop to prevent damage to wiring, headlining etc. 
- Clean the area of any debris and apply silicone or urethane sealer (natural cure sealants only) under the rails and to the drilled rivet holes. 
- Attach rails to the roof of vehicle using 16mm rivets and as shown.

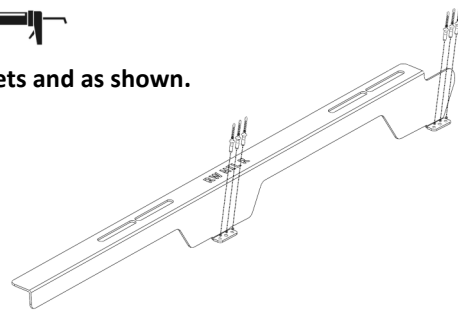

Ensure the centre of the rivet is covered with the silicone to prevent water ingress

3

- Place the Front rails (Engraved RW HIL F) at 20mm from the rear rails as shown below .
- Repeat Step 1 & 2 to secure the front rails

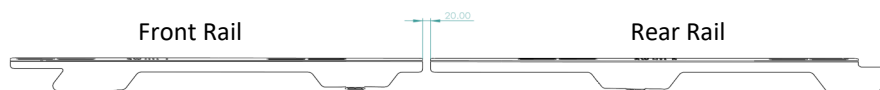

Ensure the centre of the rivet is covered with the silicone to prevent water ingress

4

- Attach the channel nuts to the top of rail and the correct slot  
(Front Slot: Tailgate Model & Rear Slot: Barn Door) .
    - Fit 10mm Bolt / Split washer/ Flat washer / Channel Nuts to the top of rail.
- \* Channel nuts to the top as shown in the following diagram

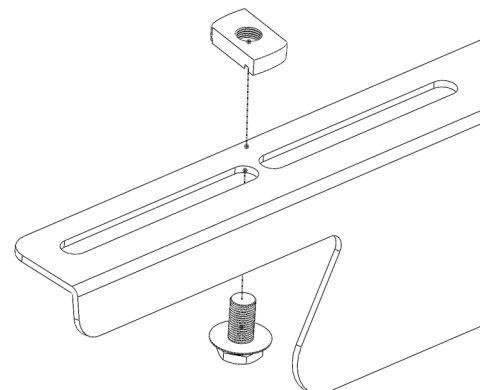

# Wedgetail Trade Rails and Platform Fitting Instruction

To suit—Hyundai iLoad Van 2008—On

RW-HIL-2514



5

- Place the Wedgetail Trade Platform on the rails (Wind deflector mounting towards the front of vehicle), then spin the channel nuts 90 degree in the channel on the underside of the rack till they lock into the channels. Do not tighten fully.

**NOTE—** Align the rack to the suitable position and clearance for roller if fitted



Around 20-30mm from the tailgate to the back of the rack or roller is sufficient

6

- Centralize the rack side to side (using a tape measure) on the Wedgetail Trade rails.

7

- Fully tighten remaining bolts in the following order:
  1. Rails to the lugs
  2. Rails to platform
  3. Attach wind Deflector using M8 hardware as shown below

**NOTE—**Ensure the channel nuts are 90 degrees to the channels.



Check fastenings are firmly tensioned at regular intervals.

Do not overtighten, this will preserve the spring washers.



**Fitting Note:**

Where a wind deflector is used, we recommend a minimum of 15mm clearance from the vehicle roof.

Where necessary manually adjust the wind deflector or wind deflector mountings as required.

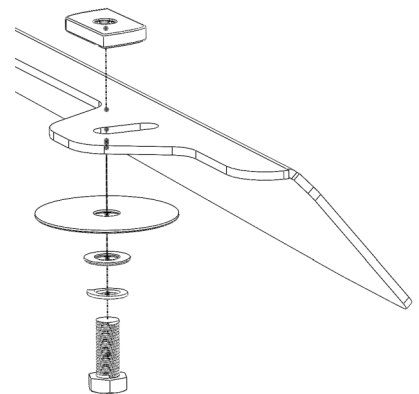

Thank you for your purchase.

Please complete your warranty application following correct installation.

Wedgetail Trade by Tradesman Roof Racks

Innovation through Inspiration