

Wedgetail Trade Rails and Platform Fitting Instruction

To suit—LDV Deliver 7 2024-On SWB

RWM-LDVD7S-2716



Congratulations on the purchase of your Australian made Wedgetail Trade Roof Rack product.

Please read and follow the instructions carefully to ensure correct fitment.

Contact us if any parts appear missing, incorrect, or damaged.

Clean the roof prior to fitting the roof racks.

Tools Required:

- Spanner (13mm,17 mm)
- Silicone/urethane sealer
- Drill Bit (5mm, 9mm)

Kit Content

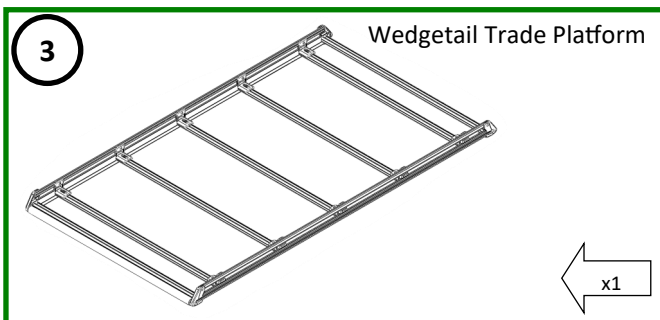

Wedgetail Trade Rails and Platform Fitting Instruction

To suit—LDV Deliver 7 2024-On SWB

RWM-LDVD7S-2716



Assemble rails to roof

1

- Place the rails on the roof of the vehicle
- Place the rear rails(Engraved LDVD7 R) in the rear position as shown below. The rear mounting plate of the rails should be placed 190mm from the rear door line.
- Place the front rails(Engraved LDVD7 F) in the front position as shown below. The distance between front and rear rail holes should be 520 mm as shown in the image below.

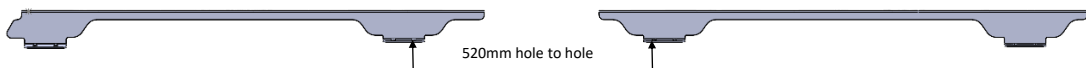
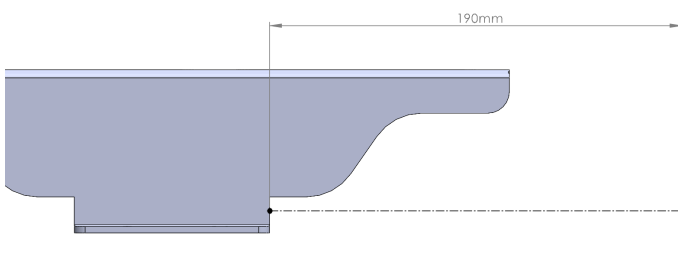

2

- Using the holes in the rail as a guide and mark all the holes centers
- Drill 5mm pilot holes in the center of all the marking. Open the holes using 9mm drill bit
- In the front most position the 3 rivet holes can be used in place of the bolts when access to the underside is difficult due to hoodlining
- Clean the area of any debris and apply silicone or urethane sealer (natural cure sealants only) under the rails and to the drilled holes.
- If roof mastic is excessive it may require removal for rails to sit correctly on roof
- Attach rails to the roof of vehicle using M8 Bolts , washer & nuts .
- Repeat the steps again on other side

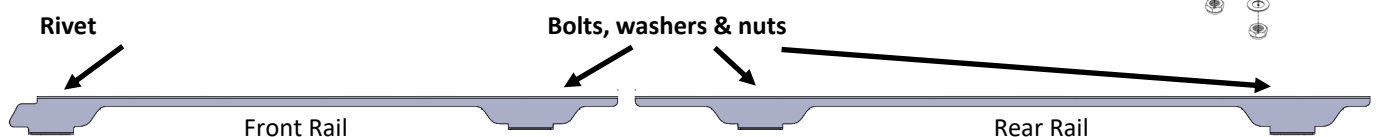
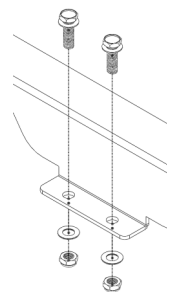
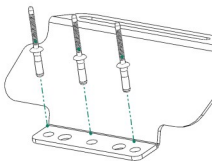

Ensure the bolts is covered with the silicone to prevent water ingress



Ensure drilling with a 20mm drill stop to prevent damage to wiring, headlining etc.

Wedgetail Trade Rails and Platform Fitting Instruction

To suit—LDV Deliver 7 2024-On SWB

RWM-LDVD7S-2716



3

- **Attach the channel nuts to the top of rail.**
 - Fit 10mm Bolt / Split washer / Flat washer / Channel Nuts to the top of rail.

* Channel nuts to the top as shown in the following diagram

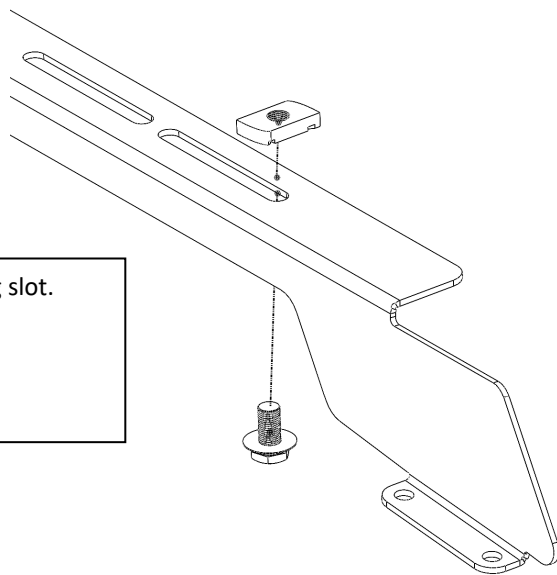

NOTE—Ensure attach the channel nuts and bolt to correct mounting slot.



Front Slot—Tailgate Version

Rear Slot—Barn Door Version

Assemble the Wedgetail Trade Platform to the rails

4

- Place the Wedgetail Trade Platform on the rails (Wind deflector mounting towards the front of vehicle), then spin the channel nuts 90 degree in the channel on the underside of the rack till they lock into the channels. Do not tighten fully.

NOTE— Align the rack to the suitable position and clearance for roller if fitted



Around 20-30mm from the tailgate to the back of the rack or roller is sufficient

5

- Centralize the rack side to side (using a tape measure) on the wedgetail rails.

Wedgetail Trade Rails and Platform Fitting Instruction

To suit—LDV Deliver 7 2024-On SWB

RWM-LDVD7S-2716



6

- Fully tighten remaining bolts in the following order:

1. Rails to the lugs
2. Rails to platform
3. Attach wind Deflector using M8 hardware as shown below

NOTE-Ensure the channel nuts are 90 degrees to the channels.



Check fastenings are firmly tensioned at regular intervals.

Do not overtighten, this will preserve the spring washers.

Fitting Note:



Where a wind deflector is used, we recommend a minimum of 15mm clearance from the vehicle roof.

Where necessary manually adjust the wind deflector or wind deflector mountings as required.

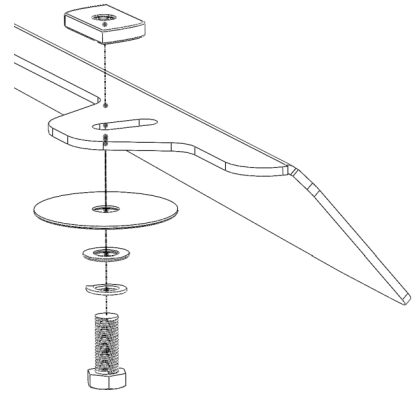

Thank you for your purchase.

Please complete your warranty application following correct installation.

Wedgetail Trade by Tradesman Roof Racks

Innovation through Inspiration