

# WedgeTail Trade Rails and Platform Fitting Instruction

To suit—Volkswagen Transporter T5/T6 SWB 2004– ON  
RW-VT5S-2714



**Congratulations on the purchase of your Australian made Wedgetail Trade Roof Rack product.**

Please read and follow the instructions carefully to ensure correct fitment.  
Contact us if any parts appear missing, incorrect, or damaged.  
Clean the roof prior to fitting the roof racks.

### Tools Required:

- Spanner (10mm,13mm,17 mm)
- Silicone/urethane sealer

### Kit Content

1

Wedgetail Trade Volkswagen T5/T6 SWB Front Left & Right Rails

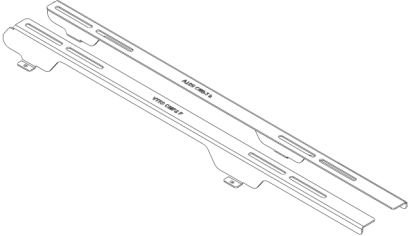

x1

2

Wedgetail Trade Volkswagen T5/T6 SWB Rear Left & Right Rails

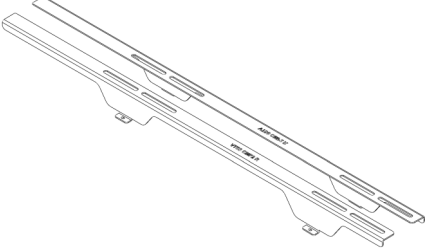

x1

3

Wedgetail Trade Platform

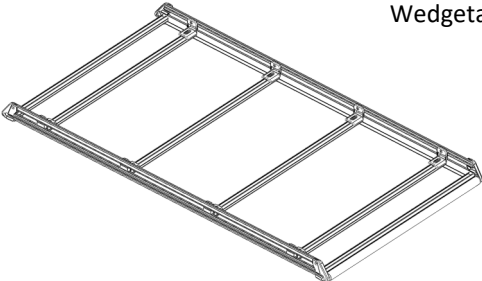

x1

4

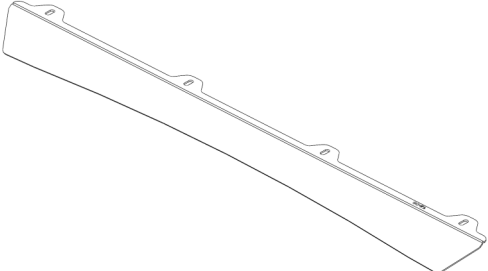

Wind Deflector Kit	
Item	Qty
Wind Deflector	1
M8 x 20 Hex Bolt	4
8mm Channel Nut	4
M8 Flat Washer	4
M8 Zinc Split Washer	4
M8 X 40 Flat Washer	4

5

M6 X 20 Hex Sems

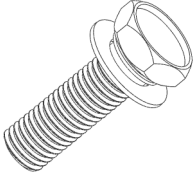

x8

6

M10 X 20 Stainless Hex Bolt

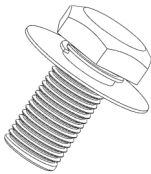

x8

7

M10 Unistrut

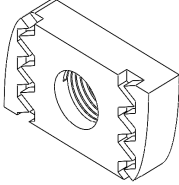

x8

# Wedgetail Trade Rails and Platform Fitting Instruction

To suit—Volkswagen Transporter T5/T6 SWB 2004– ON

RW-VT5S-2714



## Removing factory fixtures

1

- Remove the OEM bolts in the mounting positions

2

- Apply silicone on all the roof channel mounting holes to prevent any water ingress.

## Assemble rails to roof

3

- Fit rails to the vehicle using 6mm hardware

### **NOTE:**

Front Rail is marked **T5SF** pointing towards front

Rear Rail is marked **T5SR** pointing towards rear

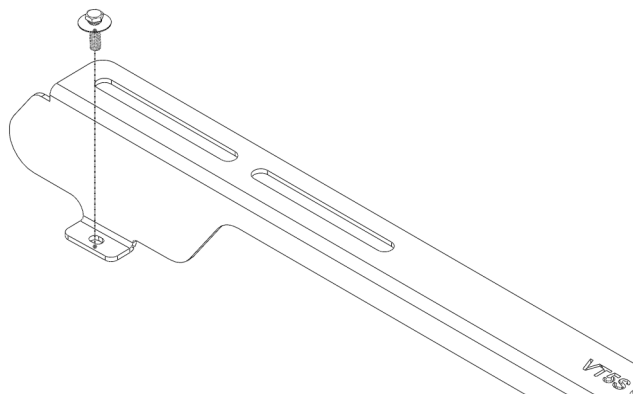

4

- Attach the channel nuts to the top of rail.

- Fit 10mm Bolt / Split washer/ Flat washer / Channel Nuts to the top of rail.

**\* Channel nuts to the top as shown in the following diagram**

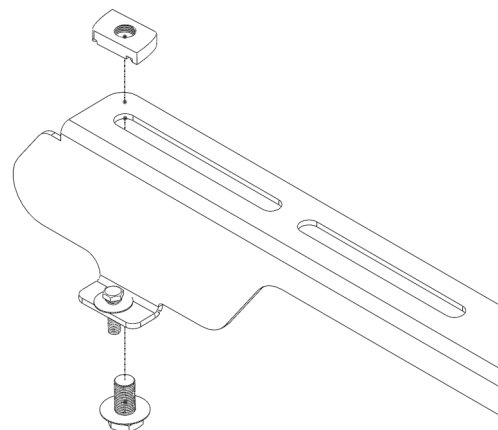

**NOTE**—Ensure attach the channel nuts and bolt to correct mounting slot.



**Front Slot—Tailgate Version**

**Rear Slot—Barn Door Version**

# Wedgetail Trade Rails and Platform Fitting Instruction

To suit—Volkswagen Transporter T5/T6 SWB 2004– ON

RW-VT5S-2714



## Assemble the Wedgetail Trade Platform to the rails

5

- Place the Wedgetail Trade Platform on the rails (Wind deflector mounting towards the front of vehicle), then spin the channel nuts 90 degree in the channel on the underside of the rack till they lock into the channels. Do not tighten fully.

**NOTE**– Align the rack to the suitable position and clearance for roller if fitted



Around 20-30mm from the tailgate to the back of the rack or roller is sufficient

6

- Centralize the rack side to side (using a tape measure) on the wedgetail rails.

7

- Fully tighten remaining bolts in the following order:
  1. Rails to the lugs
  2. Rails to platform
  3. Attach wind Deflector using M8 hardware as shown below

**NOTE**–Ensure the channel nuts are 90 degrees to the channels.



Check fastenings are firmly tensioned at regular intervals.

Do not overtighten, this will preserve the spring washers.

### Fitting Note:



Where a wind deflector is used, we recommend a minimum of 15mm clearance from the vehicle roof.

Where necessary manually adjust the wind deflector or wind deflector mountings as required.

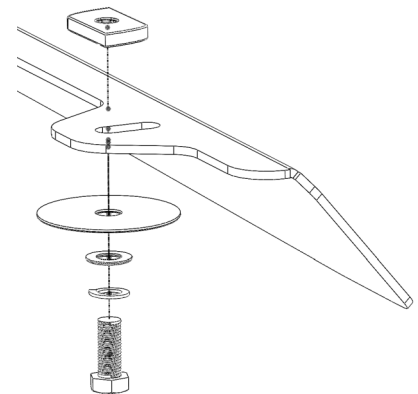

Thank you for your purchase.

Please complete your warranty application following correct installation.

Wedgetail Trade by Tradesman Roof Racks

Innovation through Inspiration