

Congratulations on the purchase of your Australian made Commercial-Max Roof Rack product.

Please read and follow the instructions carefully to ensure correct fitment.

Contact us if any parts appear missing, incorrect, or damaged.

Clean the roof prior to fitting the roof racks.

Tools Required:

- Spanner (13 & 17 mm)
- Silicone/urethane sealer

Kit Content

1 Commercial-Max Ford Transit SWB AV Front Left & Right Rails

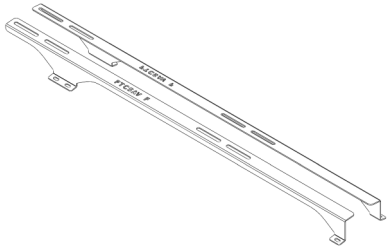

x1

2 Commercial-Max Ford Transit SWB AV Rear Left & Right Rails

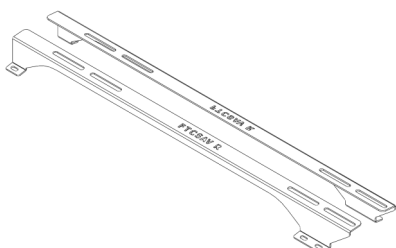

x1

3 Trademax Crossbar

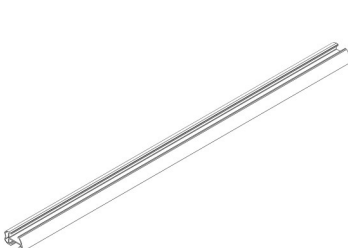

x3

4

M8 X 25 Sems Bolt Hex

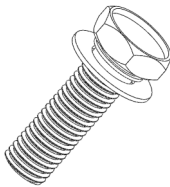

x12

5

M10 X 25 Stainless Hex Bolt

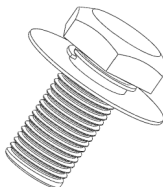

x6

6

M10 Unistrut

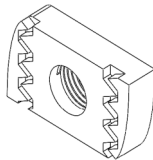

x6

7

WT Rubber

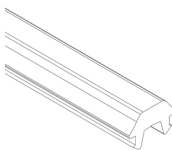

Length (mm)	Qty
1170	1
150	2

Assemble lugs to roof

1

- Remove 6 OEM plastic caps per sides in the roof channel to expose the factory mounting points.

2

- Apply silicone on all the roof channel mounting holes to prevent any water ingress.

3

- Place the supplied rails to the roof.
- Mount each rails on the roof using 8mm Bolts and washers

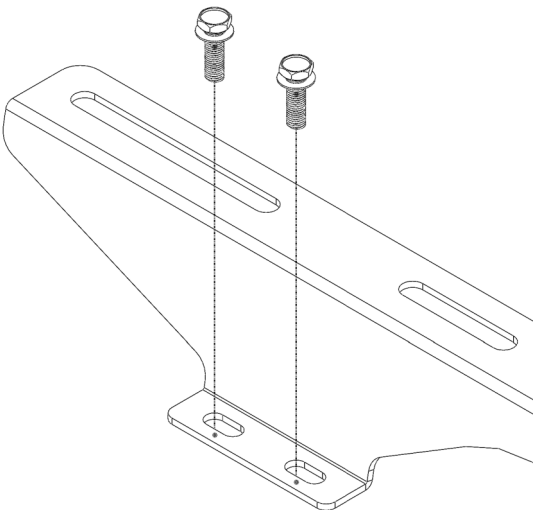

4

- Attach the channel nuts to the top of rail.
- Fit 10mm Bolt / Split washer/ Flat washer / Channel Nuts to the top of rail.

* Channel nuts to the top as shown in the following diagram

NOTE-Ensure attach the channel nuts and bolt to correct mounting slot.



- Front Slot—lift up tailgate
- Rear Slot—Barn Door Version

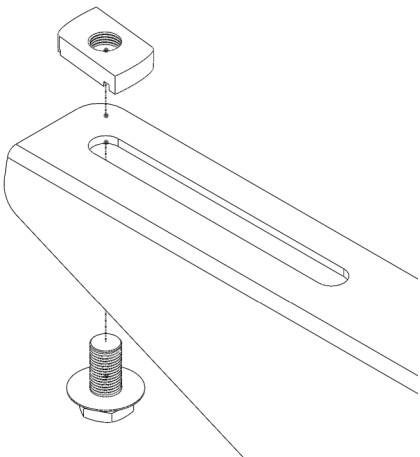

Assemble the Commercial-Max Platform to the rails

5

- Place the Trademax Crossbar on the rails in the desired position
- Ensure the crossbar placed in the correct orientation
- Spin the channel nuts 90 degree in the channel on the underside of the rack till they lock into the channels. Do not tighten fully.

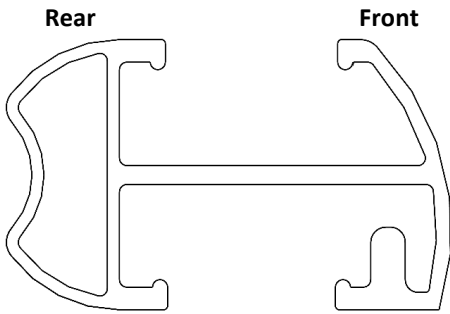

6

- Centralize the rack side to side (using a tape measure) on the Commercial-Max rails.

7

- Fully tighten remaining bolts in the following order:
 1. Rails to the lugs
 2. Rails to Crossbar

NOTE-Ensure the channel nuts are 90 degrees to the channels.



Check fastenings are firmly tensioned at regular intervals.
Do not overtighten, this will preserve the spring washers.

8

- Insert the crossbar rubber on top of the crossbar
- Insert the extra crossbar rubber under the front crossbar
- Insert End cap at the both side of the crossbar

Thank you for your purchase.

Please complete your warranty application following correct installation.

TradeMax by Tradesman Roof Racks

Innovation through Inspiration