

Wedgetail Rails and Platform Fitting Instruction

To suit—Ford Ranger T6.2 Dual Cab 2022-On



WT-FRT62-1412UC

Congratulations on the purchase of your Australian made Wedgetail Roof Rack product.

Please read and follow the instructions carefully to ensure correct fitment.

Contact us if any parts appear missing, incorrect, or damaged.

Clean the roof prior to fitting the roof racks.

Tools Required:

- Hex key (6 mm)
- Spanner (13 & 17 mm)
- 5mm Drill Bit
- Silicone/urethane sealer

Kit Content

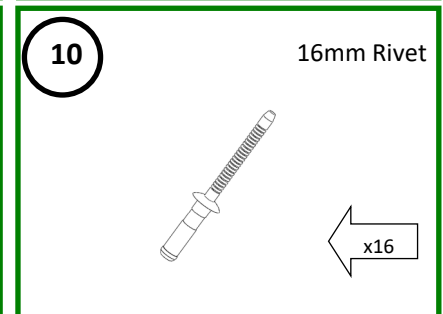
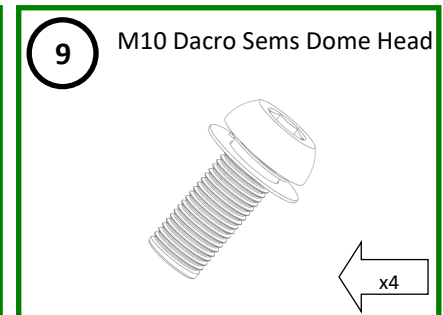
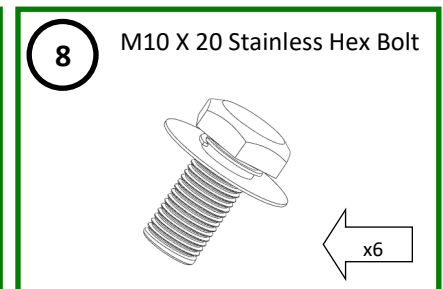
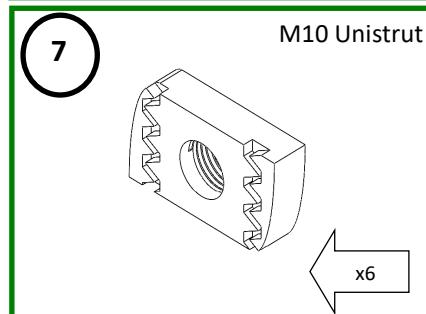
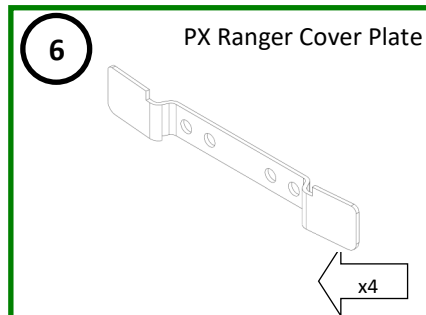
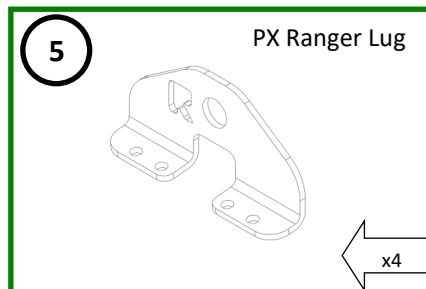
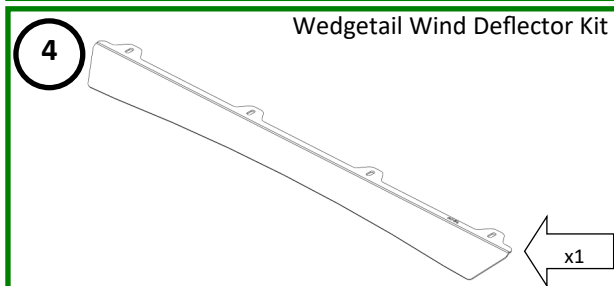
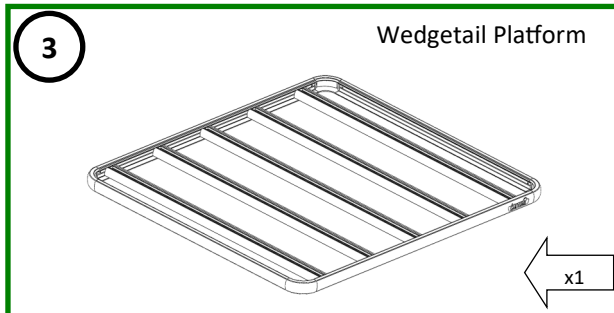
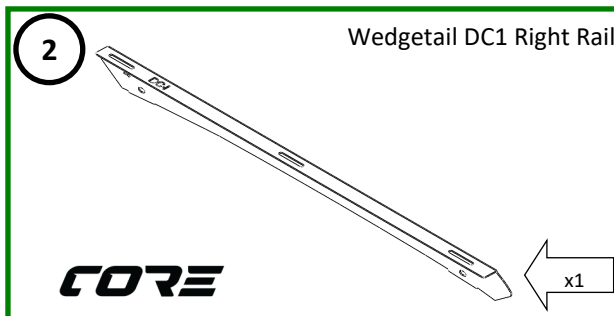
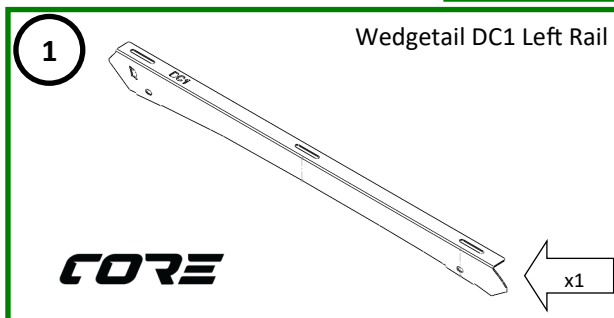

Assemble lugs to roof

1

The roof channel rubber should be cut to allow the Wedgetail Rail mounting lugs to be riveted within the roof channel. And the photos below indicate where the mountings are to be positioned.



Centre of Front Mounting Lug approx 290mm from windscreen edge

Centre distance between front mounting lug & Rear Mounting Lug 995mm

- To cut the roof rubber, first mark the strip cut locations with a suitable marker. Then Lift the rubber trim using a suitable panel lever. The strip can then be cut in the appropriate place with a sharp Stanley knife.
- You should ensure the cut sections correspond with the 2 centre mounting holes in the Wedgetail rail prior cutting the rubber, Also the Roof rack should be positioned according to your desired position on the roof taking into consideration wind deflector

2

- Place mounting Lug in the roof channel as per measurements shown in above diagrams. Drill all 4 mounting holes in each lug using a 5mm drill with drill stop, drilling one at a time then placing a rivet through hole to keep lined up (DO NOT RIVET IN PLACE YET) before drilling the next.



When drilling rivet mounting holes ensure you use a Drill stop on your drill to ensure headlining, wiring or curtain airbags are not damaged.

3

- Paint all holes using either an enamel or acrylic paint (to apply you can use a cotton bud if paint brush is not available).

4

Apply silicone or urethane sealer (natural cure sealants only) to the 5mm drilled rivet holes.

Wedgetail Rails and Platform Fitting Instruction

To suit—Ford Ranger T6.2 Dual Cab 2022-On



WT-FRT62-1412UC

5

- Attach lugs to the roof of vehicle using 5mm rivets and as shown.

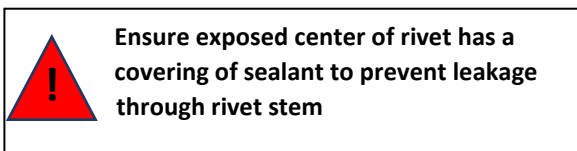

Ensure exposed center of rivet has a covering of sealant to prevent leakage through rivet stem

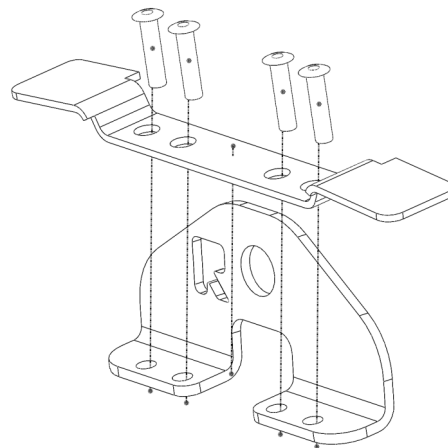

Assemble rails to lugs

6

- Attach Rails to lugs using 10mm hardware with the wedgetail logo facing to the front of the vehicle. Refer to the picture.

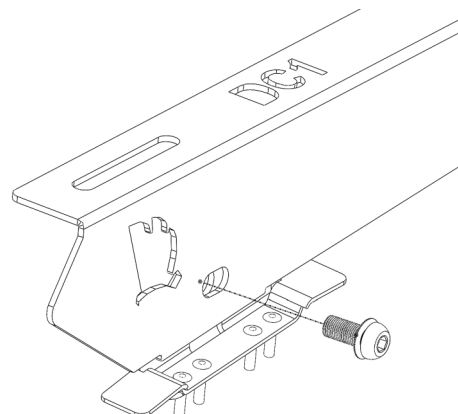

7

- Attach the channel nuts to the top of rail.
 - Fit 10mm Bolt / Split washer / Flat washer / Channel Nuts to the top of rail.

* Channel nuts to the top as shown in the following diagram

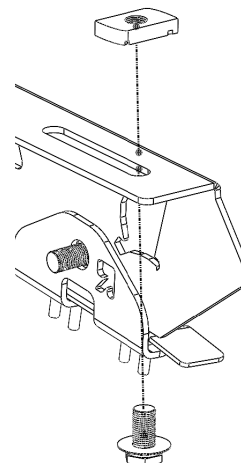

Wedgetail Rails and Platform Fitting Instruction

To suit—Ford Ranger T6.2 Dual Cab 2022-On



WT-FRT62-1412UC

Assemble the Wedgetail Platform to the rails

8

- Place the Wedgetail Platform on the rails (Wind deflector mounting towards the front of vehicle), then spin the channel nuts 90 degree in the channel on the underside of the rack till they lock into the channels. Do not tighten fully.

9

- Centralize the rack side to side (using a tape measure) on the wedgetail rails.

10

- Fully tighten remaining bolts in the following order:

1. Rails to the lugs
2. Rails to platform
3. Attach wind Deflector.

NOTE-Ensure the channel nuts are 90 degrees to the channels.



Check fastenings are firmly tensioned at regular intervals.

Do not overtighten, this will preserve the spring washers.



Fitting Note:

Where a wind deflector is used, we recommend a minimum of 15mm clearance from the vehicle roof.

Where necessary manually adjust the wind deflector or wind deflector mountings as required.

Thank you for your purchase.

Please complete your warranty application following correct installation.

Wedgetail by Tradesman Roof Racks

Innovation through Inspiration

Congratulations on the purchase of your Australian made Wedgetail Roof Rack product.

Please read and follow the instructions carefully to ensure correct fitment.

Contact us if any parts appear missing, incorrect, or damaged.

Contact us if any question about the size of platform to ensure the correct fitment

Scan QR code for a fitting demonstration



Tools Required:

- Hex key (5mm)

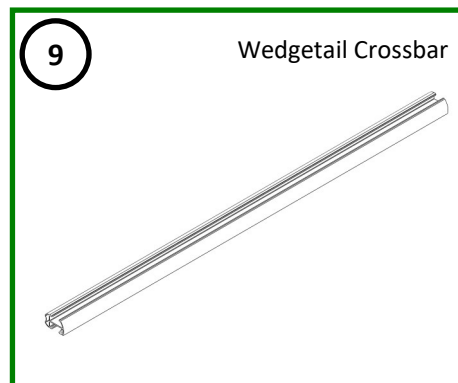
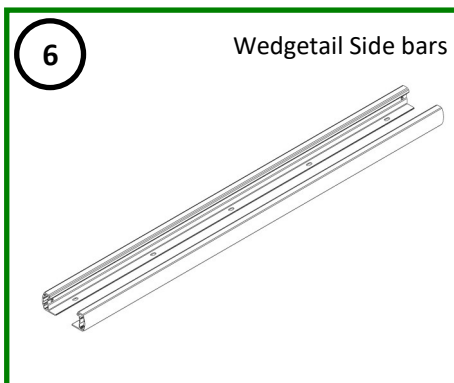
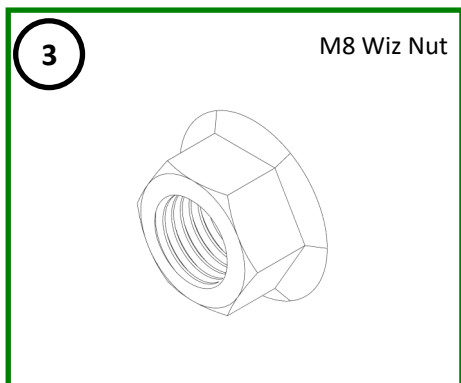
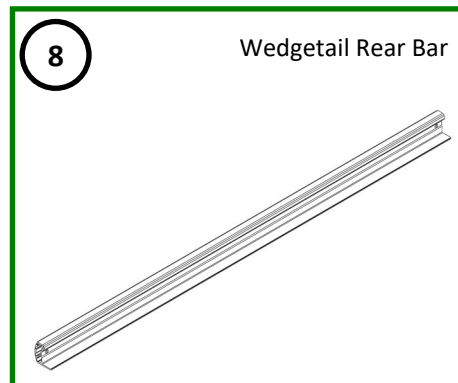
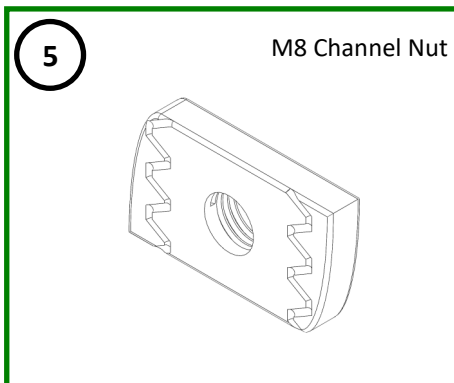
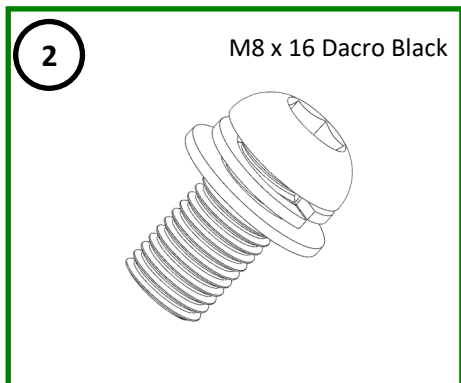
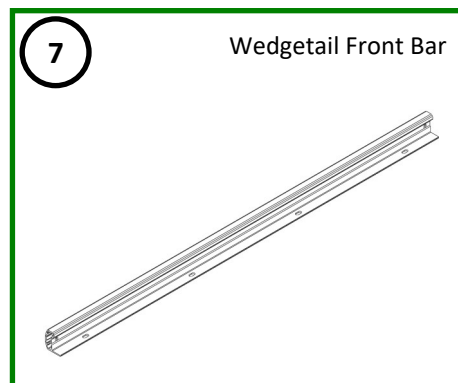
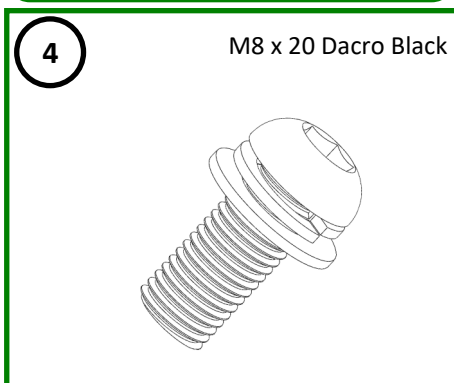
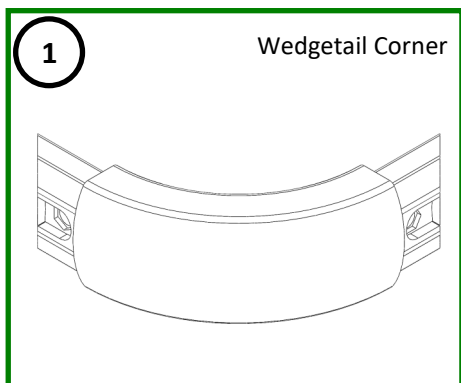

Note:

The amount of components and length of the platform are different based on the platform size ordered.

Please refer to table on Page 2 and confirm before assembly. If any question, please contact our team member.

Wedgetail Platform Fitting Instruction



WTP

| KIT CONTENTS | | | | | | | | | |
|--|-------------------|--------------------------------------|-----------------------------|--------------------------------------|---------------------------------|---------------------------|-------------------------------|-----------------------------|------------------------------|
| Item | <u>1</u> | <u>2</u> | <u>3</u> | <u>4</u> | <u>5</u> | <u>6</u> | <u>7</u> | <u>8</u> | <u>9</u> |
| <u>WT Platform Size</u> | <u>WT Corners</u> | <u>M8 x 16</u> <u>Dacro Black</u> | <u>M8 Wiz</u> <u>Nut</u> | <u>M8 x 20</u> <u>Dacro Black</u> | <u>M8</u> <u>Channel Nut</u> | <u>WT</u> <u>Sides</u> | <u>WT Front</u> <u>Bar</u> | <u>WT End</u> <u>Bar</u> | <u>WT</u> <u>Crossbar</u> |
| 0814 | 4 | 8 | 8 | 6 | 6 | 2 | 1 | 1 | 3 |
| 1112, | | | | 8 | 8 | | | | 4 |
| 1411,1412,1413, 14135,1414,1415 ,1416,1513 | | | | 10 | 10 | | | | 5 |
| 1613,1614,1617, 1812,1813 | | | | 12 | 12 | | | | 6 |
| 2012,2013,20135 ,2014,2019 | | | | 14 | 14 | | | | 7 |
| 2212,2213,2214 | | | | 16 | 16 | | | | 8 |
| 2514,2516 | | | | 18 | 18 | | | | 9 |
| 2814 | | | | 20 | 20 | | | | 10 |
| 3014,3015,3016, 3316 | | | | 22 | 22 | | | | 11 |
| 3616 | | | | 26 | 26 | | | | 13 |
| 4015 | | | | 28 | 28 | | | | 14 |
| 4215 | | | | 30 | 30 | | | | 15 |
| 4614,4615 | | | | 32 | 32 | | | | 16 |
| 5014 | | | | 38 | 38 | | | | 19 |

1

- Assemble your Wedgetail roof rack on a soft surface or blanket to avoid damage to powder coat finish.

2

- Arrange the front, rear, side bars and corners as per figure 1 to begin assembling the perimeter section.

3

- Place the flange nut in the recess as shown in the diagram (flange outwards).

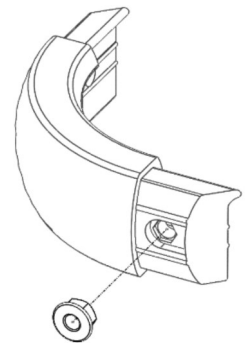

| Item used in this step | |
|------------------------|------------|
| Item 1 | WT Corner |
| Item 3 | M8 Wiz Nut |

4

- Hold the flange nut within the recess and insert it into the perimeter extrusion. Use a soft mallet if required. Repeat the process for all 4 corners.

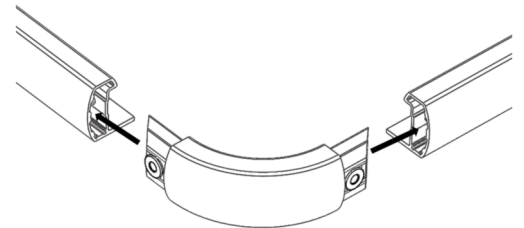

| Item used in this step | |
|------------------------|------------|
| Item 1 | WT Corner |
| Item 3 | M8 Wiz Nut |
| Item 6 | WT Sides |
| Item 7 | WT Front |
| Item 8 | WT End |

5

- Fasten all the corners to the bars using M8X16 bolt and washer. Note: Take care not to cross thread when fastening.

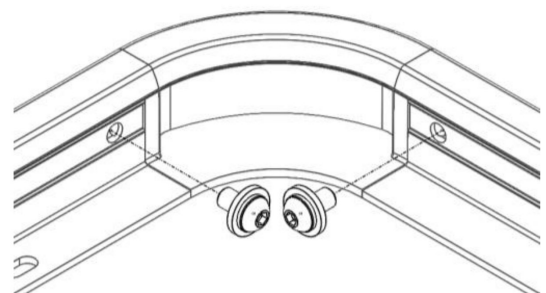

| Item used in this step | |
|------------------------|---------------------|
| Item 2 | M8 X 16 Dacro Black |

6

- Now turn the rack upside down to access slotted holes for crossbar fitment.

7

- Insert the crossbars within the recess of perimeter extrusion. The crossbar should face forward as shown for best noise and wind resistance.

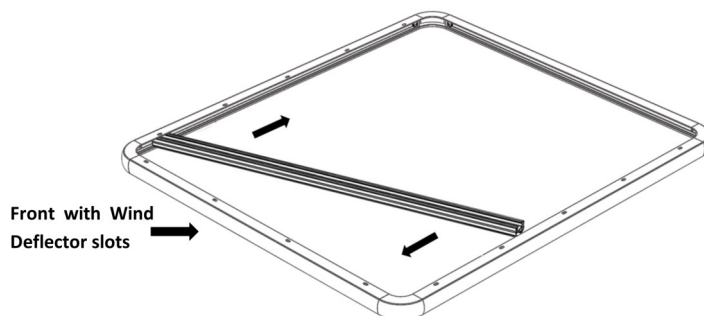

Item used in this step

Item 9

CrossBar

8

- When assembling refer to the image below for right crossbar orientation.

Underside of platform

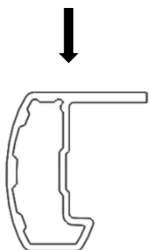

This side faces front of the vehicle

Underside of platform

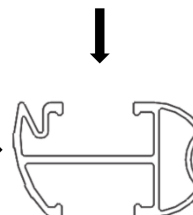

9

- Insert the remaining crossbars to the platform.

10

- Fasten the M8 X 20 bolt & washer and the channel nut.

Item used in this step

Item 4

M8 X 20 Dacro Black

Item 5

M8 Channel Nut

NOTE-Ensure the channel nuts are 90 degrees to the channels.



Check fastenings are firmly tensioned at regular intervals.

Do not overtighten, this will preserve the spring washers.

Thank you for your purchase.

Wedgetail by Tradesman Roof Racks

Innovation through Inspiration