

Wedgetail Rails and Platform Fitting Instruction

To suit Toyota Hilux AN120 Dual Cab 2016—On



WT-THDC16-1412UC

Congratulations on the purchase of your Australian made Wedgetail Roof Rack product.

Please read and follow the instructions carefully to ensure correct fitment.

Contact us if any parts appear missing, incorrect, or damaged.

Clean the roof prior to fitting the roof racks.

Tools Required:

- Hex key (6 mm)
- Spanner (13 & 17 mm)
- 5mm Drill Bit
- Silicone/urethane sealer

Kit Content

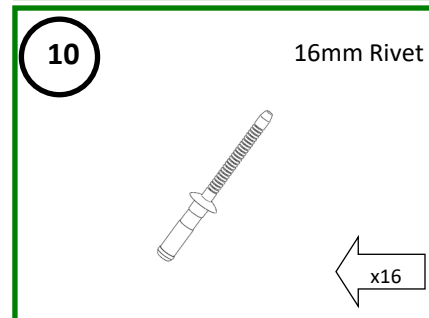
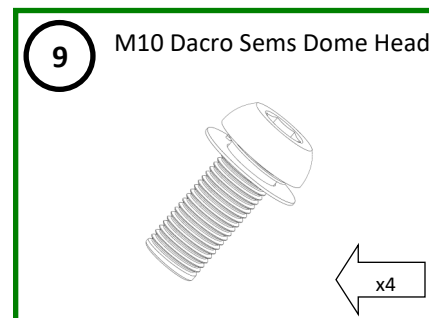
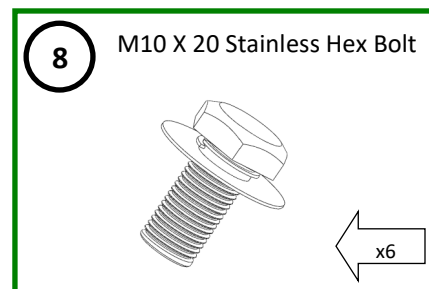
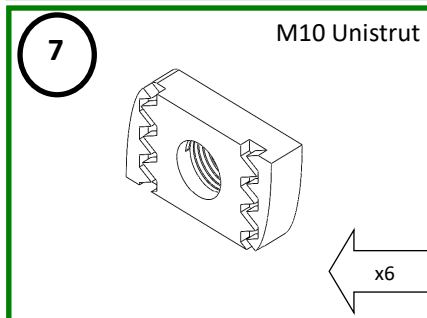
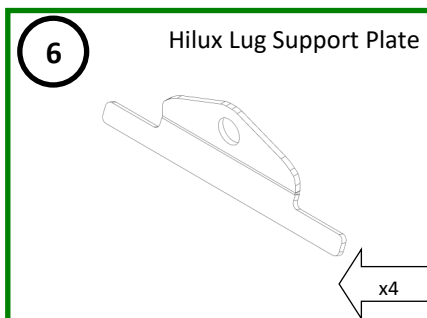
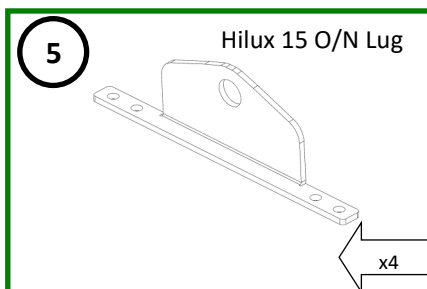
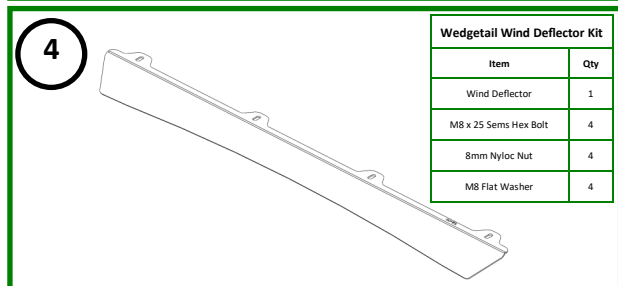
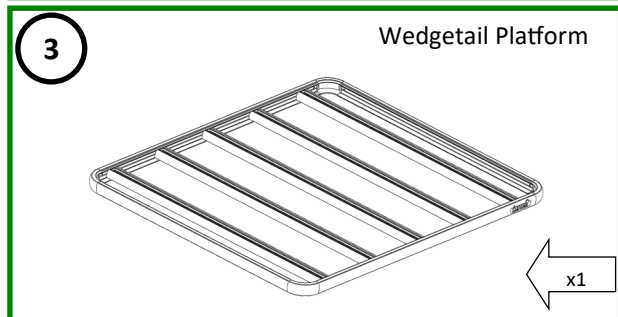
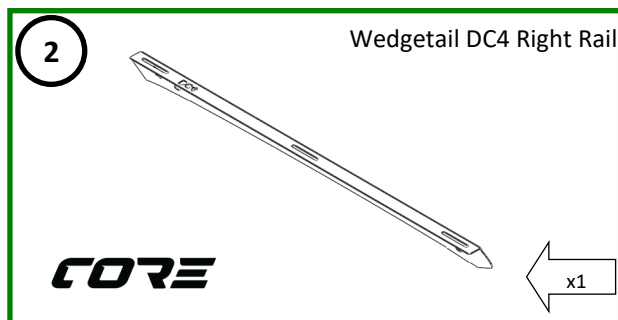
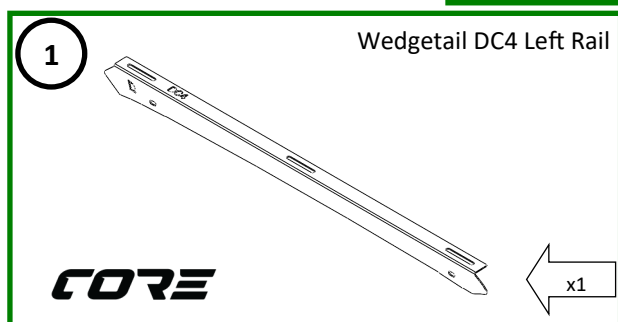

Wedgetail Rails and Platform Fitting Instruction

To suit Toyota Hilux AN120 Dual Cab 2016—On



WT-THDC16-1412UC

Locating the mounting position

1

- Position your Wedgetail rails in the preferred position on the roof taking into consideration vehicle aerial and desired position for light bar or wind deflector clearance as shown. Ideally take the rails lug mounting hole centre to 335mm from the Wind Screen. Mark the rail mounting holes with a marker.
- Centre distance between front mounting lug & Rear mounting lug is 995mm.

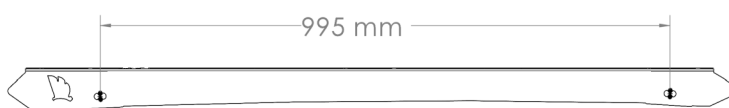

*You should ensure the cut sections correspond with the 2 centre mounting holes in the Wedgetail rail prior cutting the channel rubber

2

- Mark mounting lug position.
- Trim roof channel rubber to either side of mounting lug



When drilling rivet mounting holes ensure you use a Drill stop on your drill to ensure headlining, wiring or curtain airbags are not damaged.

3

- Paint all holes using either an enamel or acrylic paint (to apply you can use a cotton bud if paint brush is not available).
- Apply silicone or urethane sealer (natural cure sealants only) under the whole lug and to the 5mm drilled rivet holes.
- Attach lugs to the roof of vehicle using 5mm rivets and as shown.
- To retain rubber strip in place apply a small amount of silicone sealant if required

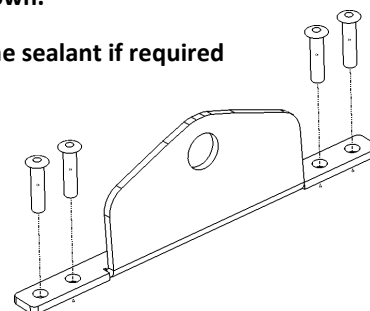

Ensure the centre of the rivet is covered with the silicone to prevent water ingress

Wedgetail Rails and Platform Fitting Instruction

To suit Toyota Hilux AN120 Dual Cab 2016—On



4

- Place the supporting plate at the position of the lug as shown for strengthening reason.

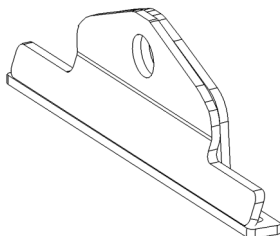

5

- Repeat Step 2-4 again for the other side of vehicle
- Clean the roof and rubber of any dirt / loose rubber pieces from cutting and drilling

6

- Attach Rails to lugs and supporting plate using 10mm hardware with the wedgetail logo facing to the front of the vehicle. Refer to the picture.

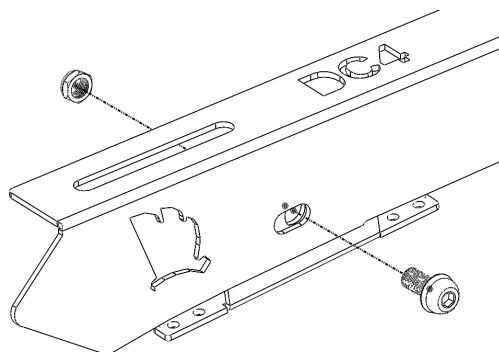

7

- Attach the channel nuts to the top of rail.
 - Fit 10mm Bolt / Split washer / Flat washer / Channel Nuts to the top of rail.

* Channel nuts to the top as shown in the following diagram

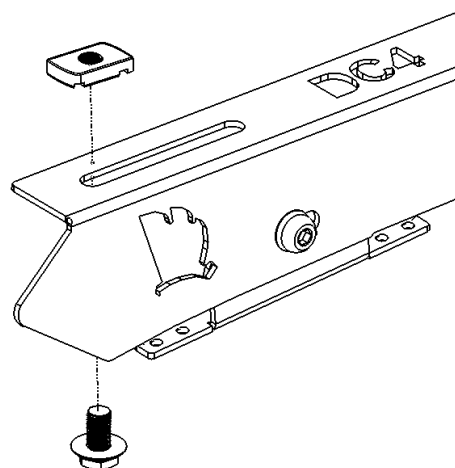

Wedgetail Rails and Platform Fitting Instruction

To suit Toyota Hilux AN120 Dual Cab 2016—On



WT-THDC16-1412UC

Assemble the Wedgetail Platform to the rails

8

- Place the Wedgetail Platform on the rails (Wind deflector mounting towards the front of vehicle), then spin the channel nuts 90 degree in the channel on the underside of the rack till they lock into the channels. Do not tighten fully.

9

- Centralize the rack side to side (using a tape measure) on the wedgetail rails.

10

- Fully tighten remaining bolts in the following order:
 1. Rails to the lugs
 2. Rails to platform
 3. Attach wind Deflector.

NOTE-Ensure the channel nuts are 90 degrees to the channels.



Check fastenings are firmly tensioned at regular intervals.

Do not overtighten, this will preserve the spring washers.



Fitting Note:

Where a wind deflector is used, we recommend a minimum of 15mm clearance from the vehicle roof.

Where necessary manually adjust the wind deflector or wind deflector mountings as required.

Thank you for your purchase.

Please complete your warranty application following correct installation.

Wedgetail by Tradesman Roof Racks

Innovation through Inspiration

Congratulations on the purchase of your Australian made Wedgetail Roof Rack product.

Please read and follow the instructions carefully to ensure correct fitment.

Contact us if any parts appear missing, incorrect, or damaged.

Contact us if any question about the size of platform to ensure the correct fitment

Scan QR code for a fitting demonstration



Tools Required:

- Hex key (5mm)

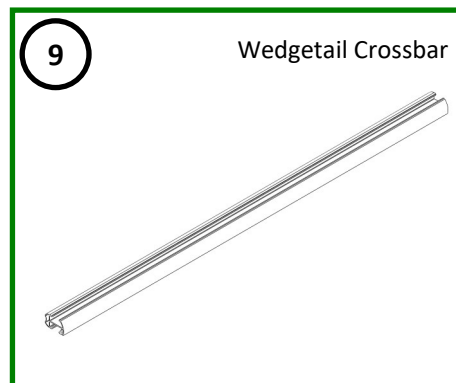
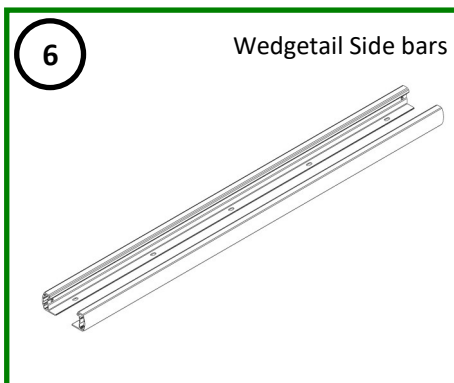
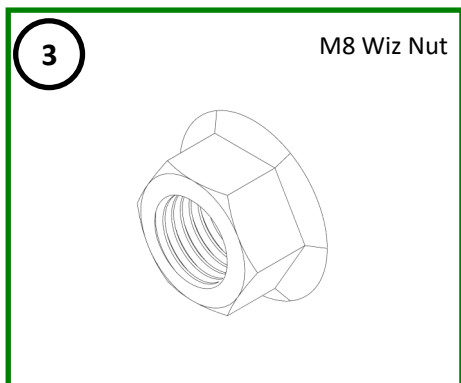
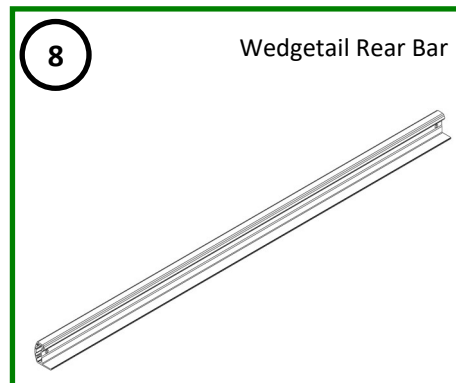
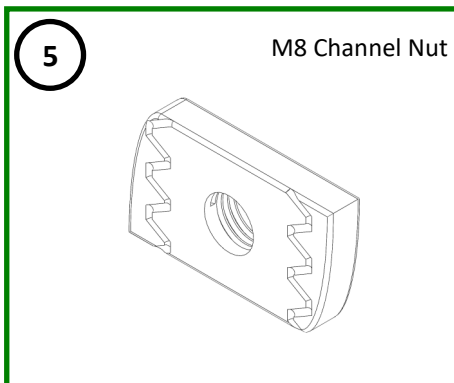
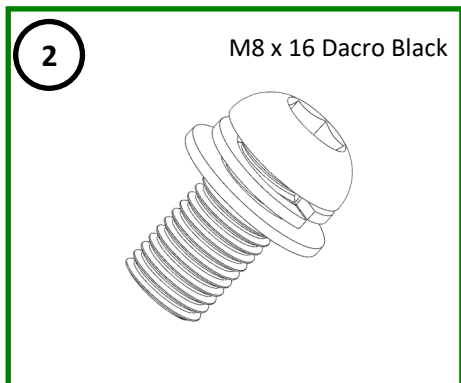
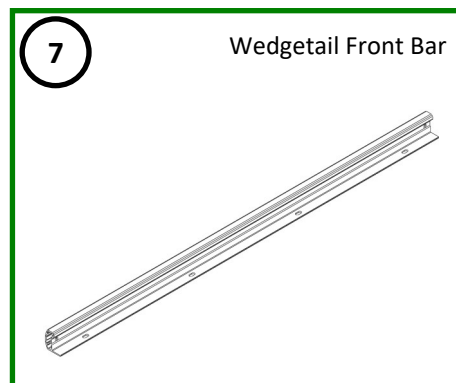
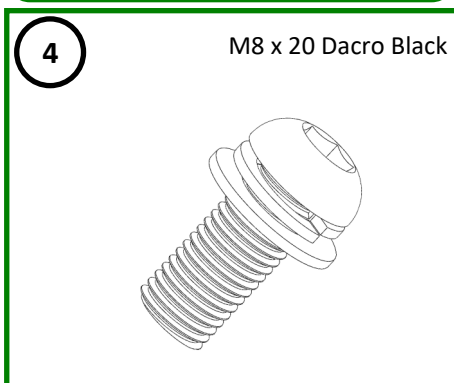
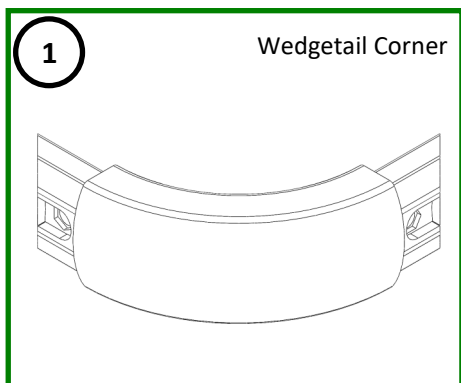

Note:

The amount of components and length of the platform are different based on the platform size ordered.

Please refer to table on Page 2 and confirm before assembly. If any question, please contact our team member.

Wedgetail Platform Fitting Instruction



WTP

KIT CONTENTS									
<u>Item</u>	<u>1</u>	<u>2</u>	<u>3</u>	<u>4</u>	<u>5</u>	<u>6</u>	<u>7</u>	<u>8</u>	<u>9</u>
<u>WT Platform Size</u>	<u>WT Corners</u>	<u>M8 x 16</u> <u>Dacro Black</u>	<u>M8 Wiz</u> <u>Nut</u>	<u>M8 x 20</u> <u>Dacro Black</u>	<u>M8</u> <u>Channel Nut</u>	<u>WT</u> <u>Sides</u>	<u>WT Front</u> <u>Bar</u>	<u>WT End</u> <u>Bar</u>	<u>WT</u> <u>Crossbar</u>
0814	4	8	8	6	6	2	1	1	3
1112,				8	8				4
1411,1412,1413, 14135,1414,1415 ,1416,1513				10	10				5
1613,1614,1617, 1812,1813				12	12				6
2012,2013,20135 ,2014,2019				14	14				7
2212,2213,2214				16	16				8
2514,2516				18	18				9
2814				20	20				10
3014,3015,3016, 3316				22	22				11
3616				26	26				13
4015				28	28				14
4215				30	30				15
4614,4615				32	32				16
5014				38	38				19

1

- Assemble your Wedgetail roof rack on a soft surface or blanket to avoid damage to powder coat finish.

2

- Arrange the front, rear, side bars and corners as per figure 1 to begin assembling the perimeter section.

3

- Place the flange nut in the recess as shown in the diagram (flange outwards).

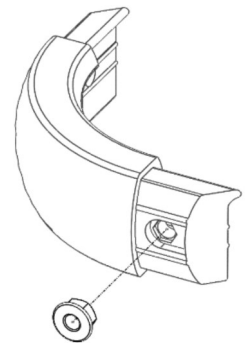

Item used in this step	
Item 1	WT Corner
Item 3	M8 Wiz Nut

4

- Hold the flange nut within the recess and insert it into the perimeter extrusion. Use a soft mallet if required. Repeat the process for all 4 corners.

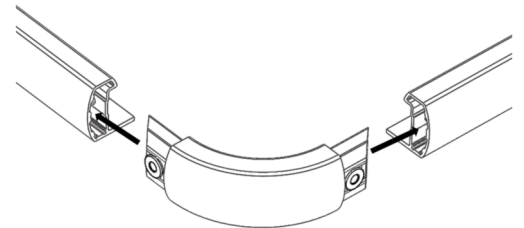

Item used in this step	
Item 1	WT Corner
Item 3	M8 Wiz Nut
Item 6	WT Sides
Item 7	WT Front
Item 8	WT End

5

- Fasten all the corners to the bars using M8X16 bolt and washer. Note: Take care not to cross thread when fastening.

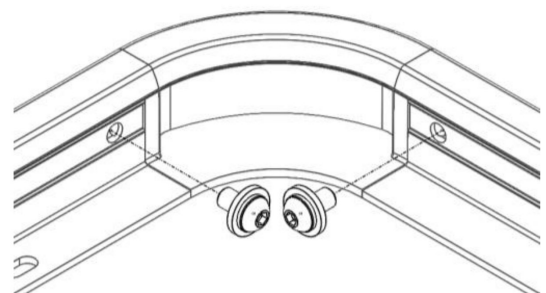

Item used in this step	
Item 2	M8 X 16 Dacro Black

6

- Now turn the rack upside down to access slotted holes for crossbar fitment.

7

- Insert the crossbars within the recess of perimeter extrusion. The crossbar should face forward as shown for best noise and wind resistance.

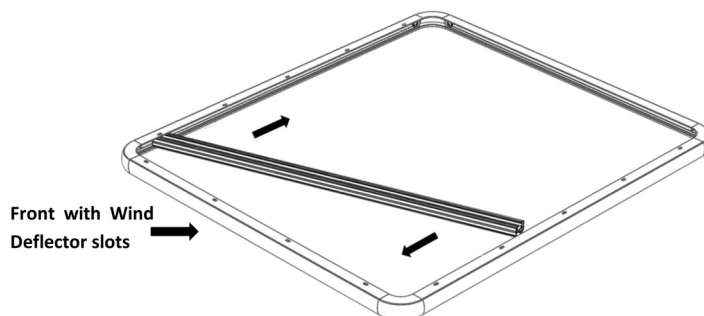

Item used in this step	
Item 9	CrossBar

Item 9

CrossBar

8

- When assembling refer to the image below for right crossbar orientation.

Underside of platform

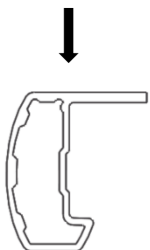

This side faces front of the vehicle

Underside of platform

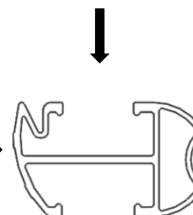

9

- Insert the remaining crossbars to the platform.

10

- Fasten the M8 X 20 bolt & washer and the channel nut.

NOTE-Ensure the channel nuts are 90 degrees to the channels.



Check fastenings are firmly tensioned at regular intervals.

Do not overtighten, this will preserve the spring washers.

Item used in this step	
Item 4	M8 X 20 Dacro Black
Item 5	M8 Channel Nut

Item 4

M8 X 20 Dacro Black

Item 5

M8 Channel Nut

Thank you for your purchase.

Wedgetail by Tradesman Roof Racks

Innovation through Inspiration