

Wedgetail Rails and Platform Fitting Instruction

To suit—Toyota Prado 250 LWB 2024-On

Lexus GX550 2024-On

WT-TP250-20135 UC

WT-GX550-20135UC



Congratulations on the purchase of your Australian made Wedgetail Roof Rack product.

Please read and follow the instructions carefully to ensure correct fitment.

Contact us if any parts appear missing, incorrect, or damaged.

Clean the roof prior to fitting the roof racks.

Scan QR code for a fitting demonstration



Tools Required:

- Hex key (5 & 6 mm)
- Spanner (13 & 17 mm)
- Silicone/urethane sealer

Kit Content

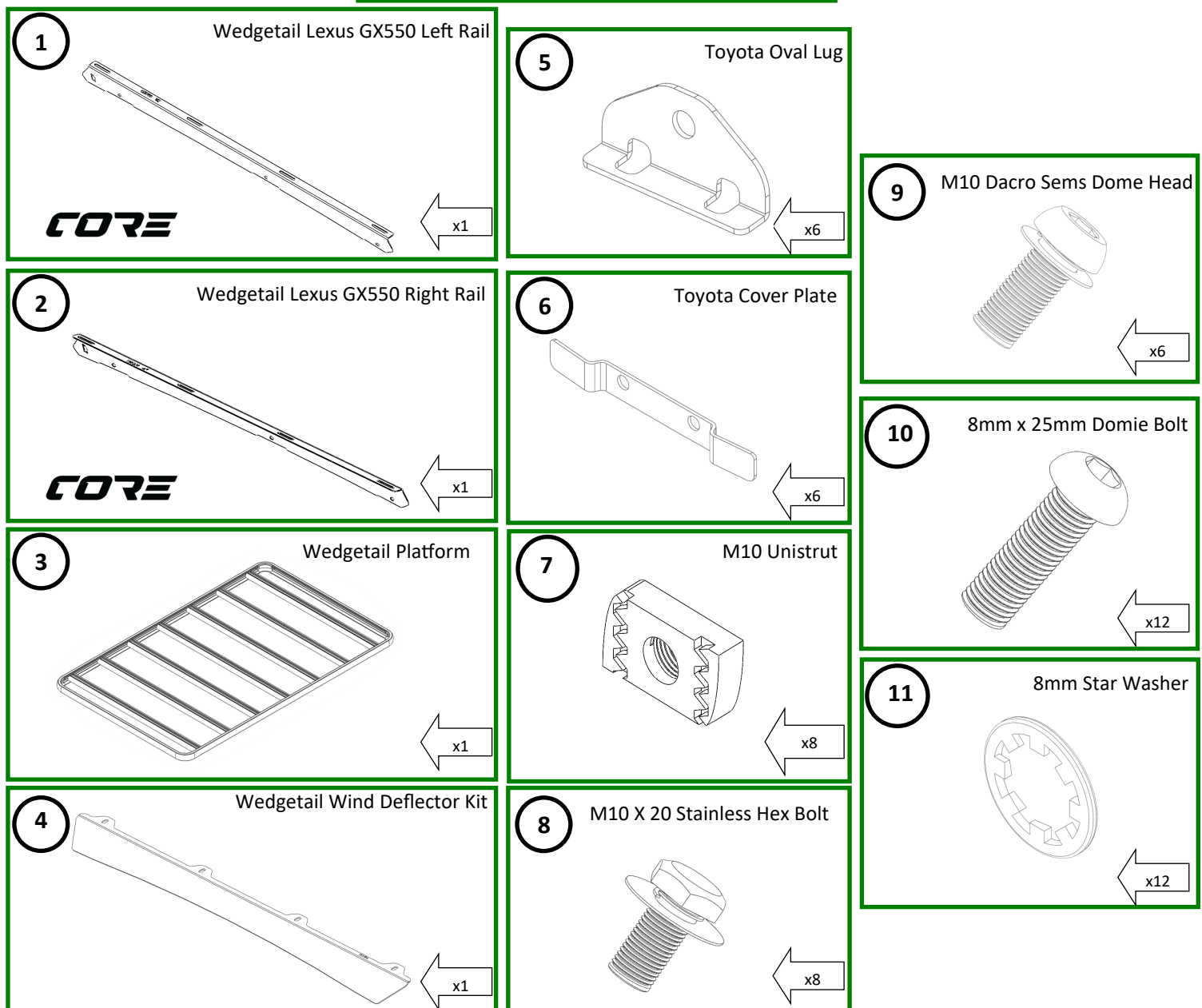

WT-GX550-20135_Fitting_Rev2 Updated

Updated: 17 Mar 2025

COPYRIGHT TRADESMAN ROOF RACKS | WEDGETAILRACK.COM.AU

Wedgetail Rails and Platform Fitting Instruction

To suit—Toyota Prado 250 LWB 2024-On

Lexus GX550 2024-On

WT-TP250-20135 UC

WT-GX550-20135UC



Factory Rail Removal (Please proceed to step 5 if vehicle has slimline factory rails or No rails)

1

- Remove plastic caps from factory rails to expose the factory mounting point

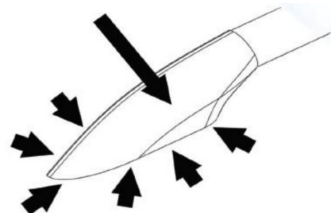

2

- Using a flat head screw driver place in the join between the plastic cap and backing plate. Pull cover outwards until clips let go.

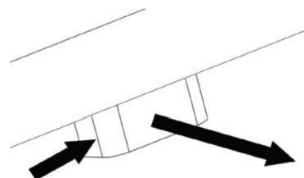

3

- Removing the centre mount cover use a small flathead screwdriver place in the side of the mount between the plastic cover and the metal part of the rail. Pull the plastic out towards you until the clips let go.

4

- Undo mounting bolts (WARNING, LOOSEN ALL BOLTS FIRST THEN REMOVE, DO NOT LOOSEN AND REMOVE ONE BOLT AT A TIME AS THIS MAY CAUSE THE RETAINING PLATES TO DROP INSIDE THE ROOF LINING). Lift rails off and discard, leaving the rubber channel strips in place. Remove cover strip in roof channel just back from the front mount and remove both bolts (loosen both bolts first then remove). Discard all mounting hardware. Go to step 6.

Removing factory slim line rails / mount points fastenings

5

- Remove plastic cover strips in the roof channels, pushing them forward (locate small slot in cap, insert flat screwdriver to lever up) Then remove all bolts in roof (WARNING, LOOSEN ALL BOLTS FIRST THEN REMOVE, DO NOT LOOSEN AND REMOVE ONE BOLT AT A TIME AS THIS MAY CAUSE THE RETAINING PLATES TO DROP INSIDE THE ROOF LINING), discard all hardware removed.

6

- Apply silicone or urethane sealer (natural cure sealants only) to the mounting holes.
- Fit 6 rail mounting lugs and cover plates using 8mm hardware (as per diagram below).

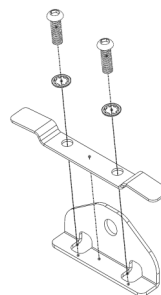

Wedgetail Rails and Platform Fitting Instruction

To suit—Toyota Prado 250 LWB 2024-On

Lexus GX550 2024-On

WT-TP250-20135 UC

WT-GX550-20135UC



7

- Attach rails to the lugs using 10mm hardware (as per diagram below). Do not fully tighten.

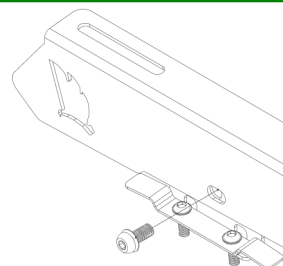

8

- Attach the channel nuts to the top of rail.
 - Fit 10mm Bolt / Split washer/ Flat washer / Channel Nuts to the top of rail.

* Channel nuts to the top as shown in the following diagram

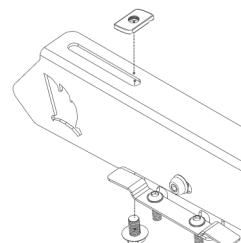

Assemble the Wedgetail Platform to the rails

9

- Place the Wedgetail Platform on the rails (Wind Deflector mounting towards the front of vehicle), then spin the channel nuts 90 degrees in the channel on the underside of the rack till they lock into the channels. Don't tighten fully

10

- Centralize the rack side to side (using a tape measure) on the wedgetail rails.

11

- Fully tighten remaining bolts in the following order:

1. Rails to the lugs
2. Rails to platform
3. Attach wind Deflector.

NOTE-Ensure the channel nuts are 90 degrees to the channels.



Check fastenings are firmly tensioned at regular intervals.

Do not overtighten, this will preserve the spring washers.



Fitting Note:

Where a wind deflector is used, we recommend a minimum of 15mm clearance from the vehicle roof.

Where necessary manually adjust the wind deflector or wind deflector mountings as required.

Thank you for your purchase.

Please complete your warranty application following correct installation.

Wedgetail by Tradesman Roof Racks

Innovation through Inspiration

Congratulations on the purchase of your Australian made Wedgetail Roof Rack product.

Please read and follow the instructions carefully to ensure correct fitment.

Contact us if any parts appear missing, incorrect, or damaged.

Contact us if any question about the size of platform to ensure the correct fitment

Scan QR code for a fitting demonstration



Tools Required:

- Hex key (5mm)

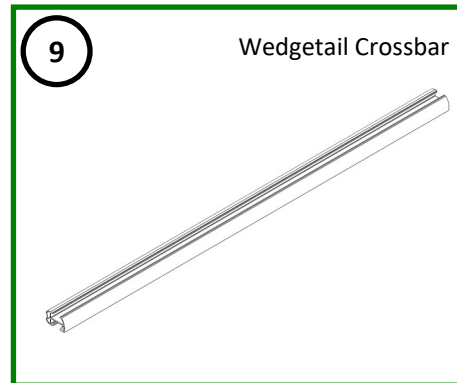
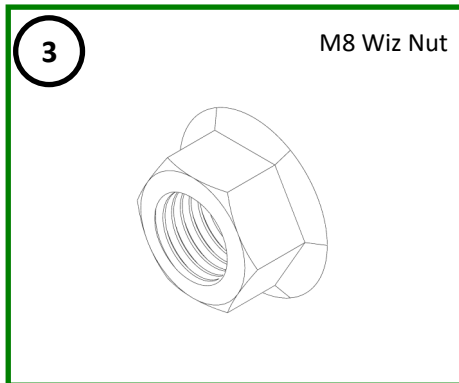
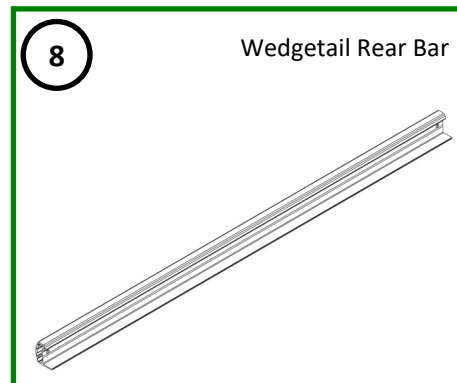
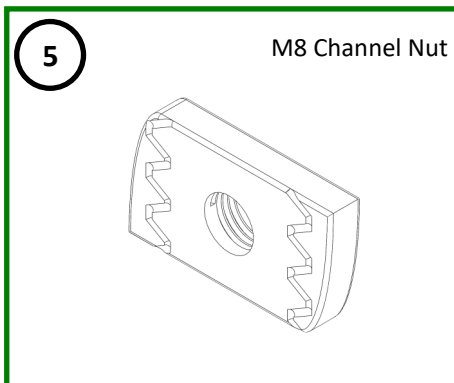
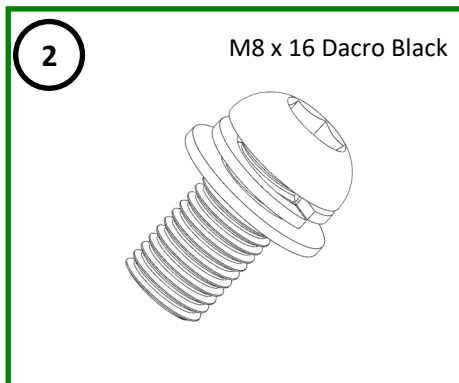
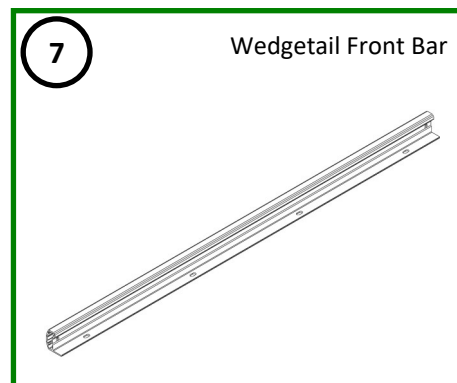
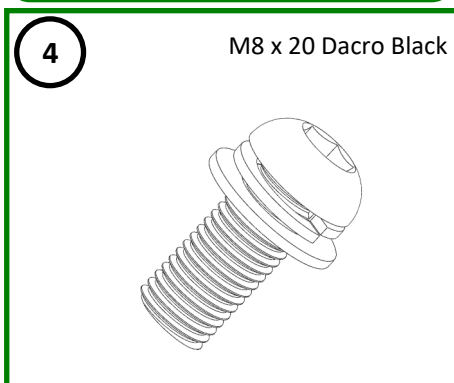
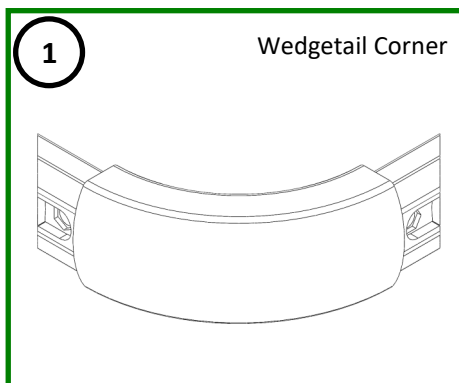

Note:

The amount of components and length of the platform are different based on the platform size ordered.

Please refer to table on Page 2 and confirm before assembly. If any question, please contact our team member.

Wedgetail Platform Fitting Instruction



WTP

KIT CONTENTS									
<u>Item</u>	<u>1</u>	<u>2</u>	<u>3</u>	<u>4</u>	<u>5</u>	<u>6</u>	<u>7</u>	<u>8</u>	<u>9</u>
<u>WT Platform Size</u>	<u>WT Corners</u>	<u>M8 x 16</u> <u>Dacro Black</u>	<u>M8 Wiz</u> <u>Nut</u>	<u>M8 x 20</u> <u>Dacro Black</u>	<u>M8</u> <u>Channel Nut</u>	<u>WT</u> <u>Sides</u>	<u>WT Front</u> <u>Bar</u>	<u>WT End</u> <u>Bar</u>	<u>WT</u> <u>Crossbar</u>
0814	4	8	8	6	6	2	1	1	3
1112,				8	8				4
1411,1412,1413, 14135,1414,1415 ,1416,1513				10	10				5
1613,1614,1617, 1812,1813				12	12				6
2012,2013,20135 ,2014,2019				14	14				7
2212,2213,2214				16	16				8
2514,2516				18	18				9
2814				20	20				10
3014,3015,3016, 3316				22	22				11
3616				26	26				13
4015				28	28				14
4215				30	30				15
4614,4615				32	32				16
5014				38	38				19

1

- Assemble your Wedgetail roof rack on a soft surface or blanket to avoid damage to powder coat finish.

2

- Arrange the front, rear, side bars and corners as per figure 1 to begin assembling the perimeter section.

3

- Place the flange nut in the recess as shown in the diagram (flange outwards).

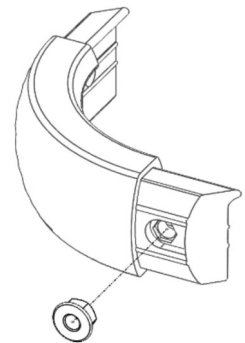

Item used in this step	
Item 1	WT Corner
Item 3	M8 Wiz Nut

4

- Hold the flange nut within the recess and insert it into the perimeter extrusion. Use a soft mallet if required. Repeat the process for all 4 corners.

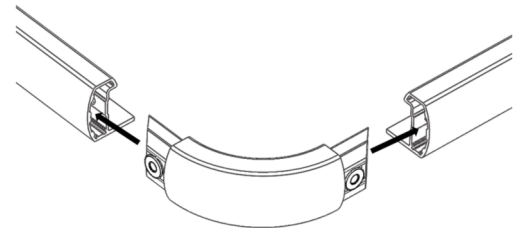

Item used in this step	
Item 1	WT Corner
Item 3	M8 Wiz Nut
Item 6	WT Sides
Item 7	WT Front
Item 8	WT End

5

- Fasten all the corners to the bars using M8X16 bolt and washer. Note: Take care not to cross thread when fastening.

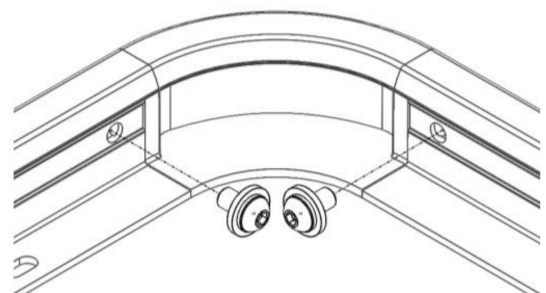

Item used in this step	
Item 2	M8 X 16 Dacro Black

6

- Now turn the rack upside down to access slotted holes for crossbar fitment.

7

- Insert the crossbars within the recess of perimeter extrusion. The crossbar should face forward as shown for best noise and wind resistance.

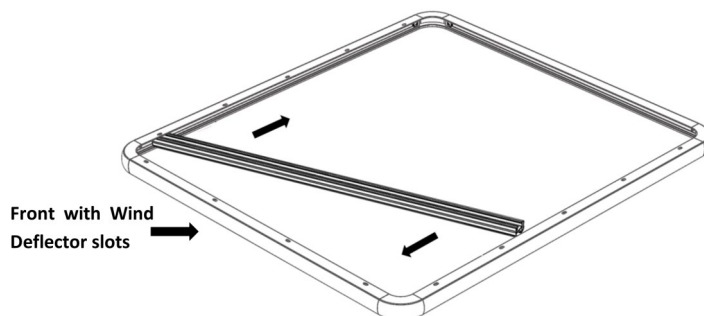

Item used in this step	
Item 9	CrossBar

Item 9

CrossBar

8

- When assembling refer to the image below for right crossbar orientation.

Underside of platform

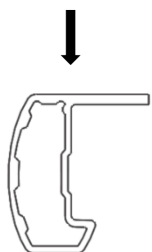

Underside of platform

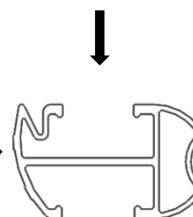

This side faces front
of the vehicle

9

- Insert the remaining crossbars to the platform.

10

- Fasten the M8 X 20 bolt & washer and the channel nut.

NOTE-Ensure the channel nuts are 90 degrees to the channels.



Check fastenings are firmly tensioned at regular intervals.

Do not overtighten, this will preserve the spring washers.

Item used in this step	
Item 4	M8 X 20 Dacro Black
Item 5	M8 Channel Nut

Item 4

M8 X 20 Dacro Black

Item 5

M8 Channel Nut

Thank you for your purchase.

Wedgetail by Tradesman Roof Racks

Innovation through Inspiration