



WT-IDMAX20-1412  
WT-HC13-1412  
WT-IDMAX-1412

Holden Colorado/ Isuzu DMAX / Isuzu DMAX20 Wedgetail  
Fitting

### INSTALLING RAILS AND ROOF RACK:

**Congratulations on the purchase of your Australian made Wedgetail Roof Rack product, please follow these instructions to ensure correct fitment.**

Mounting Installation (With Factory Points, if no factory points proceed to step 5):

1. Remove the rubber moulding covering the roof channel from the rear of the vehicle to windscreen
2. Mark the point on the rubber where roof mounting holes are located
3. Place the mounting lug on the rubber so that the centre it is aligned with the lines marked in the previous step. Mark to the left and right edge of lug on the rubber. Now neatly trim the rubber along these lines. Re install the rubber moulds checking that the lugs have clearance once rubber trim is in place.
4. Apply silicone or urethane sealer (natural cure sealants only) in and around the 8 mounting points in the roof. Now fit the 4 mounting lugs and cover plates using M8 hardware provided. Refer to diagram. Do not tighten fully.

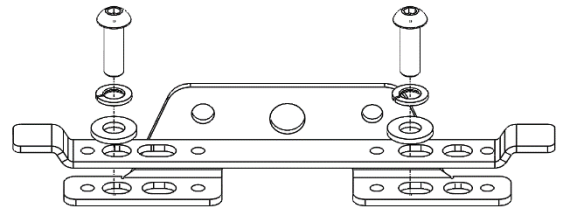

**Proceed to Step 9.**

Mounting Installation (Without Factory Points):

5. Place mounting Lug in the roof. Drill all 4 mounting holes in each lug using a 5mm drill with drill stop, drilling one at a time then placing a rivet through hole to keep lined up (DO NOT RIVET IN PLACE YET).
6. Paint all holes using either an enamel or acrylic paint (to apply you can use a cotton bud if paint brush is not available).
7. Apply silicone or urethane sealer (natural cure sealants only) to the 5mm drilled rivet holes.
8. Attach lugs to the roof of vehicle using 5mm rivets and as shown.

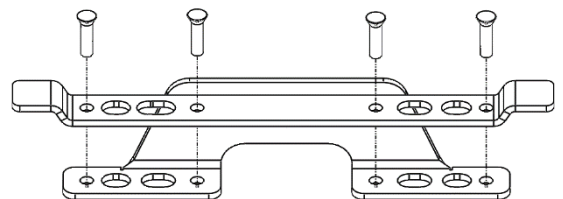



WT-IDMAX20-1412  
WT-HC13-1412  
WT-IDMAX-1412

This fitment uses Structural Non-Sealed rivets for strengthening reasons

**Silicon must be applied to the top of the rivet to prevent water ingress.**

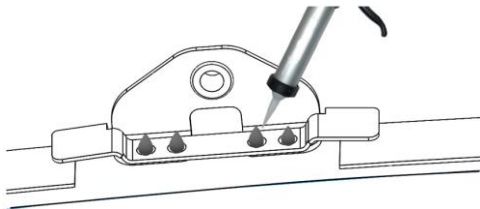

9. Attach Rails to lugs using 10mm hardware with the Wedgetail logo facing to the front of the vehicle. Refer to the diagram below. Do not tighten fully.

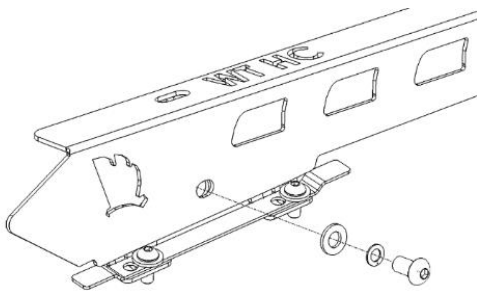

10. Tighten the mounting lug to the roof (DO NOT TIGHTEN THE RAIL TO MOUNTING LUG YET)
11. Fit 10mm Bolt / Split washer/ Flat washer with the Channel Nuts on top of the rail.

*\*Channel nuts to the top as shown in the next diagram*

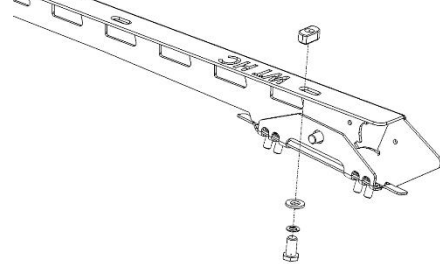

12. Place the Wedgetail Platform on the rails (Wind deflector mounting towards the front of vehicle), then spin the channel nuts 90 degree in the channel on the underside of the rack till they lock into the channels. Do not tighten fully.
13. Centralize the rack side to side (using a tape measure) on the wedgetail rails.
14. Fully tighten remaining bolts in the following order:
  - a. Rail to Lug
  - b. Rails to Platform
    - \* Ensure the channel nuts are 90 degrees to the channels in the platform
  - c. Install wind deflector using 8mm hardware

**Check fastenings are firmly tensioned at regular intervals**

**Do not overtighten so as to preserve spring washers.**

**Thank you for your purchase**

**Please complete your warranty application following correct installation**



WT-IDMAX20-1412

WT-HC13-1412

WT-IDMAX-1412

**Wedgetail by Tradesman Roof Racks**

*Innovation through Inspiration*